

SUITABLE FOR MODEL



IMAGE MAY VARY FROM ACTUAL PRODUCT

SAFETY INSTRUCTION

READ CAREFULLY BEFORE INSTALLING FIXTURE. PLEASE KEEP THIS MANUAL FOR FUTURE USING.

Fixtures must be wired in accordance with the National Electrical Code and all applicable local codes. Proper grounding is required for safety.

THIS PRODUCT MUST BE INSTALLED IN ACCORDANCE WITH THE APPLICATION CODE BY A PERSON FAMILIAR WITH THE CONSTRUCTION AND OPERATION OF THE PRODUCT AND THE HAZARDS INVOLVED. MAKE CERTAIN POWER OFF BEFORE INSTALLING OR MAINTAINING FIXTURE.

CHECK THAT VOLTAGE IS COMPATIBLE WITH FIXTURE DRIVER, USE APPROVED CONNECTORS FOR ALL ELECTRICAL CONNECTIONS.

MAINTENANCE CAUTION

1. Review the diagrams before beginning, and make sure fixture is grounded properly.
2. For lighting controls, using functioning correctly.
3. Turn power off and wait for fixture cooling to operate.
4. Maintenance must be done by professionals.

WIRE CONNECTION

Universal voltage driver permits operation at 120V thru 277V, 50 or 60Hz

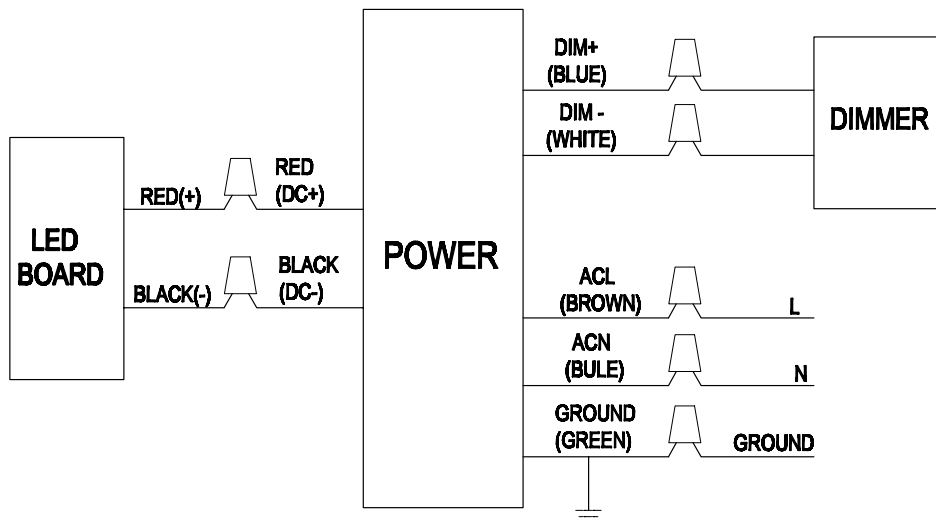

INSTALLATION

1) CEILING MOUNTING

1.1 Ceiling with loop

1. Fix the luminaire with chain to the ceiling
2. Use the buckles to fix the safety rope with the body and loop.
3. Connect the wires.

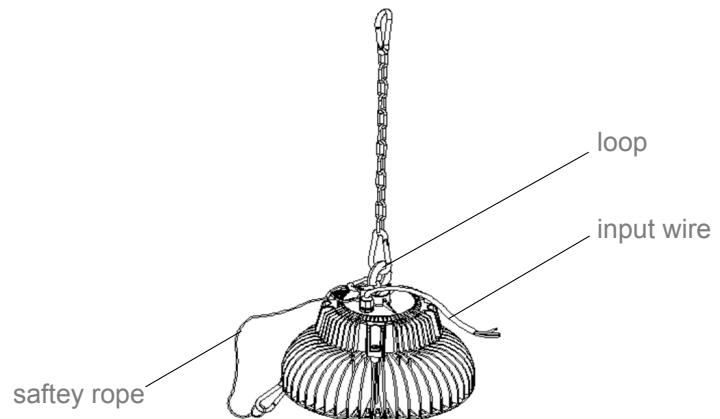

1.2 Ceiling with hook

1. Unsrew the hook, fix the luminaire to the installation holders, and screw the hook tightly.
2. Use the buckles to fix the safety rope with the body and hook.
3. Connect the wires.

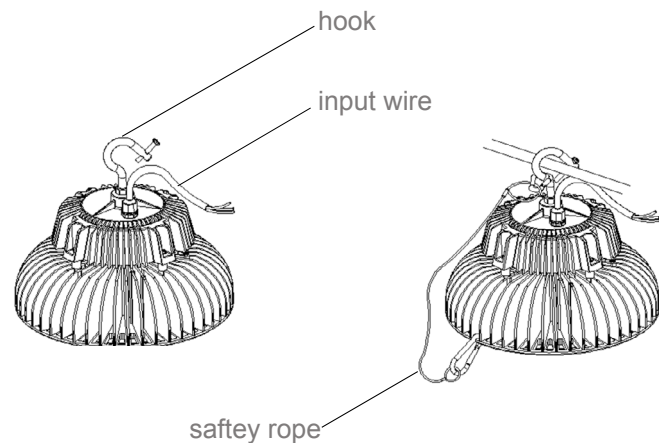

2) WALL MOUNTING

1. Trepan the installation holes as the size of the following figure
2. Use M 10 screws to tighten the luminaire. The holder can be adjusted from 60D to 120D.
3. Use the buckles to fix the safety rope with the body and ceiling .
4. Connect the wires.

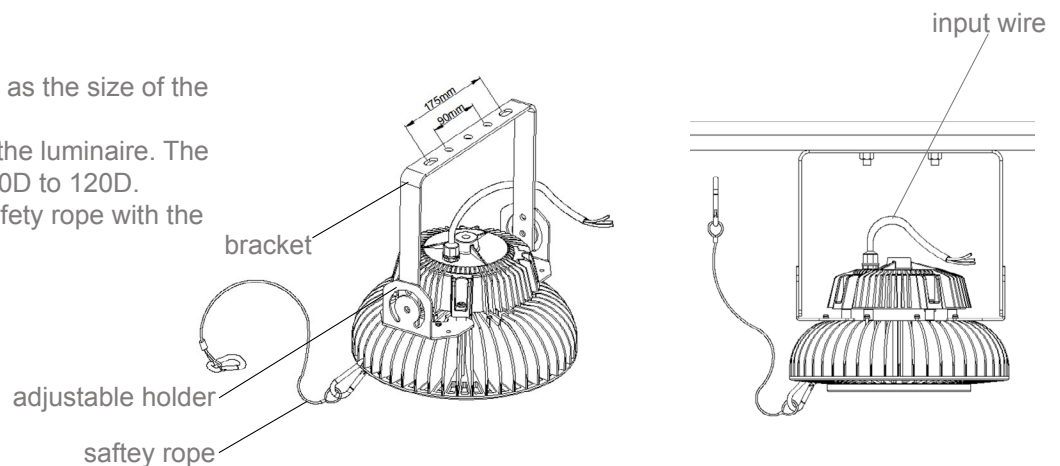

3) PENDANT MOUNTING

1. Fix the luminaire with bar and tighten the pole with anti-skid screw.
2. Use the buckles to fix the safety rope with the body and ceiling.
3. Connect the wires.

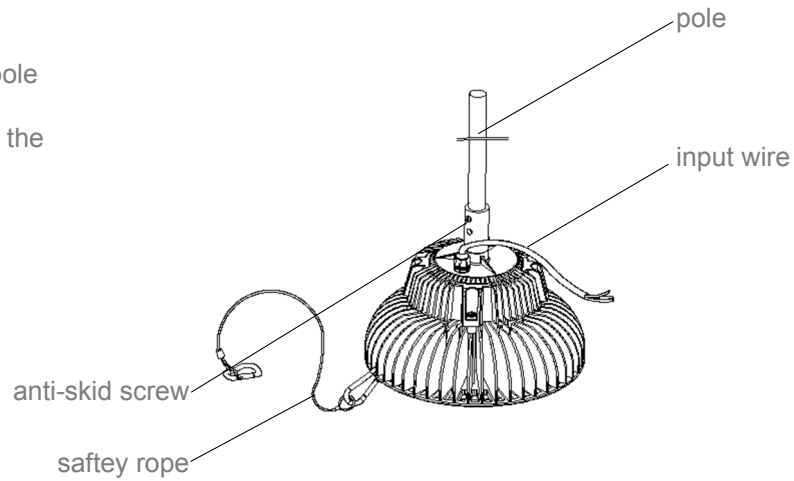

WARRANTY

LIMITED FIVE-YEAR WARRANTY. Should this product fail to perform satisfactorily due to a defect or poor workmanship within five years from the date of purchase, return it to the place of purchase and it will be replaced, free of charge. Incidental or consequential damages are excluded from the warranty.