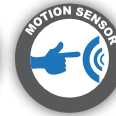



IMAGE MAY VARY FROM ACTUAL PRODUCT

LED Flood Light



PRODUCT DESCRIPTION

LED Flood light series uses a die-casting aluminum housing, simple but beautiful. It is designed to replace halogen, sodium and MH floodlights. Long lifespan, high brightness output and superior quality.

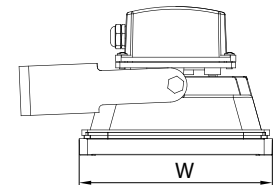
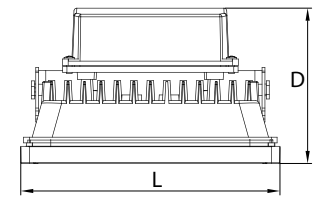

SPECIFICATION

23W	42W
Depth: 7.1"	Depth: 9"
Width: 5.5"	Width: 7.5"
Length: 4.3"	Length: 5"
Max.Weight: 4.5lbs	Max. Weight: 6.5 lbs

Ordering Information

Example: AB FL 45 LED 50 - 40

ABOVE ALL	Flood Light	Watts	Source type	CCT	Controls	Beam Angle
AB	FL	25 - 23 Watts 45 - 42 Watts	LED	30 - 3000K 40 - 4000K 50 - 5000K	MS - Multi-Level Motion Sensor	40 - 40°

Notice:

1. Standard Finish as Traditonal Bronze.
2. DLC Premium only with 5000K at present.
3. Special Order as other finish color - Ask Customer Service for Details.

PERFORMANCE DATA

LUMEN OUTPUT

Lumen values are measured by third party certified laboratories performed in accordance with IESNA LM-79-08 as well as Lighting Facts listed.

Watts	Lumen Output	AC Input 120V	Measured Watts	CRI	Beam Angle	LPW
23W	2400	0.22A	23W	>70	40°	80
42W	4300	0.39A	42W	>70		96.8

Projected LED Lumen Maintenance

Data references the extrapolated performance projections for the LED Flood light fixtures in a 77°F ambient, (tested per IESNA LM-80-08 and projected per IESNA TM-21-11).

Lumen Ambient Temperature (LAT) Multipliers

Use these factors to determine relative lumen output for average ambient temperature from -40-104°F (-40-40°C)

Ambient		Multiplier
Celsius	Fahrenheit	
0	32	1.02
10	50	1.01
20	68	1.00
25	77	1.00
30	86	1.00
40	104	0.99

Operating Hours	0	4,000	7,000	30,000	175,000
	Lumen Maintenance Factor	1.0	0.98(L98)	0.96(L96)	0.92(L92)

Photometry

All published luminaire photometric testing performed to IESNA LM-79-08 standards by a NVLAP certified laboratory.

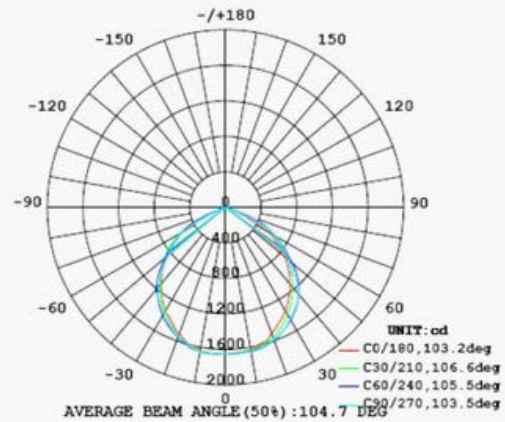
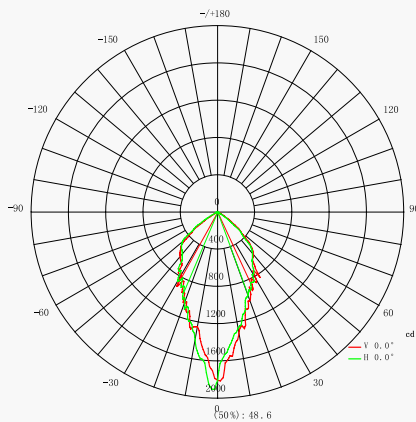

PRODUCT SPECIFICATIONS

CONSTRUCION & MATERIALS

- Housing is all aluminum construction
- Terminal block for power input suitable for #2 - #10 AWG wire
- Luminaire sides are rugged die cast aluminum with integral, weathertight LED driver compartments and high performance heat sinks
- Surface-mount directly to a vertical or horizontal surface with included mount bracket

System Wattage	Max THD (%)	Power Factor	Power Efficiency	Replaces/ Equiv.(MH)
23W	20	>0.99	90%	100W
42W	20	>0.99	90%	175W

Ref#: 10020-10504

ELECTRICAL SYSTEM

- Input Voltage: 120-277V
- 50/60Hz
- Class II driver
- Minimum ambient -40°C, maximum ambient 40°C
- Power Factor: > 0.9 at full load
- Total Harmonic Distortion: < 20% at full load

CERTIFICATIONS AND QUALIFICATIONS

- cETLus Listed
- Suitable for wet location
- IP65 rated
- DLC qualified. Please refer to <http://www.designlights.org/QPL> for most current information
- RoHS compliant
- Complies with 2013 California Title 24 building and electrical codes as a residential outdoor lighting fixture and as a commercial outdoor non-pole-mounted fixture ≤ 30 Watts

Warranty

Ten year limited warranty. Full warranty terms located at www.abovealllighting.com/warrantystatements

Note: Specifications subject to change without notice.