

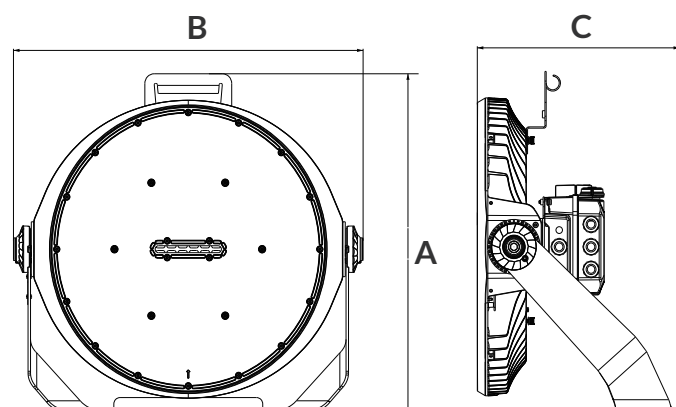

## DIMENSION

Voltage	Wattage	Luminaire Dimensions AxBxC	N.W/PC
200~480Vac	800W	526x564x326mm (20.71x22.20x12.83")	17.60kg 38.80lbs
	1200W	581x648x332mm (22.87x25.51x13.07")	25.14kg 55.42lbs



The RGB APEX Stadium Light is a professional lighting solution for sports field and high mast area lighting. Controllable with standard DMX512 or optional RDM to suit your needs. The professionally designed beam angle can target specific areas, minimizing glare and maintaining uniformity. The installation angle can be infinitely adjusted through a rotatable mechanism. It supports standard bracket installation, as well as horizontal and vertical clamp or sleeve-type pole installations.

## TECHNICAL DATA

Wattage	800W/1200W
CCT	Red/Green/Blue
Control	DMX512/RDM
Input Voltage	200-480Vac
Projected Lifetime	L70-600,000hrs @Ta=25°C
Operating Temp.	-30 to +50°C (-22 to +122°F)
Power Factor	>0.97 at full load
Harmonic Distortion	<15% at full load
IP Rating	IP66
Surge protection	20KV L-N, 20KV L/N-E
IK Rating	IK08
Certifications	UL Listed

## Features

- **Control System:** Controllable with standard DMX512 or optional RDM to suit your needs.
- **Several Mounting Options:** Trunnion, slip fitter and quick clamp pendant.
- **Optional Add-ons:** Precision aiming device and scalable visor can dramatically reduces glare and spill. The scalable visor can save 35% packaging volume.
- **Precise Control:** 12°, 17°, 22°, 45°, 60° via high performance optical lenses.

## ORDERING INFORMATION

EXAMPLE: APEX-800-RGB6-DMX-TR-60-GY

<b>APEX</b>							
Series	Wattage	CCT	Voltage	Control	Installation	Optics	Finish
<b>APEX</b>	<b>800</b> 800W	<b>RGB</b> Red Green Blue	<b>6</b> 200-480V	<b>DMX</b> DMX512 <sup>1</sup>	<b>TR</b> Trunnion <sup>2</sup>	<b>12</b> 12° 2Hx2V	<b>GY</b> Gray <sup>3</sup> sand texture (RAL870-3)
	<b>1200</b> 1200W					<b>17</b> 17° 3Hx3V	
						<b>22</b> 22° 4Hx4V	
						<b>45</b> 45° 5Hx5V	
						<b>60</b> 60° 5Hx5V	
				<b>DMXR</b> DMX/RDM enabled <sup>1</sup>			

### NOTES:

1. DMX512 is standard. RDM control is optional.
2. Trunnion is standard. Slip fitter and quick clamp adapter need to be ordered separately.
3. Gray is standard. Custom color is available at an additional charge.

## ACCESSORIES



**APEX-PAD-BK**  
Precision aiming device, black



**APEX-SF-GY**  
Slip fitter, gray



**APEX-QCA-GY**  
Quick clamp adapter, gray



**APEX-VS-800SP-GY**  
Visor for 800SP, gray

**APEX-VS-1200SP-GY**  
Visor for 1200SP, gray

## PHOTOMETRY

All published luminaire photometric testing performed to IESNA LM-79-08 standards by a NVLAP certified laboratory. IESNA LM-79-08 specifies the entire luminaire as the source resulting in a fixture efficiency of 100%. Results may vary per actual order.

### 800W

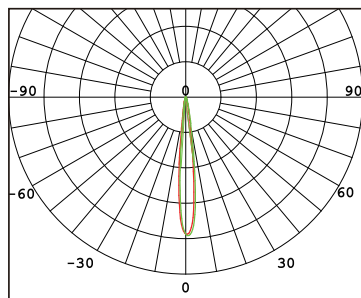

12 (NEMA 2Hx2V) LED3737 optics  
**F43201**

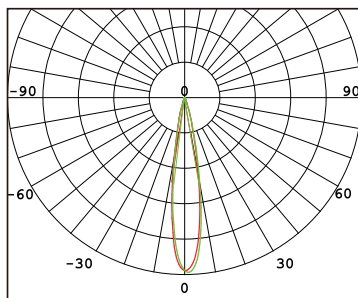

17 (NEMA 3Hx3V) LED3737 optics  
**F43202**

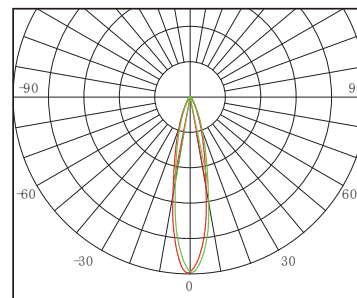

22 (NEMA 4Hx4V) LED5050 optics  
**F43223**

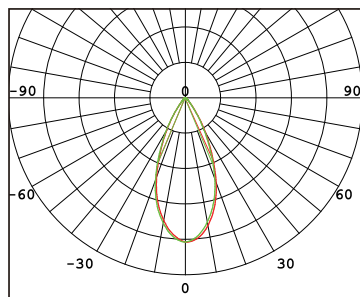

45(NEMA 5Hx5V) LED5050 optics  
**F43204**

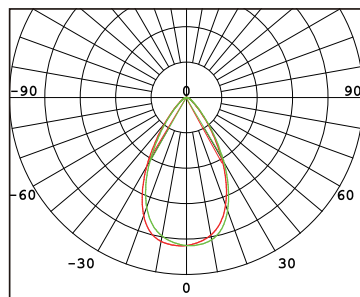

60(NEMA 5Hx5V) LED5050 optics  
**F43206**

## PRECISION LIGHT CONTROL

The optional precision aiming device, aiming angles on the bracket and scalable visor are key elements in controlling the amount of light that is directed onto the field, with correct aiming angles generally directing more light onto the field resulting in less spill and glare off site. Dramatically reduces glare and spill.

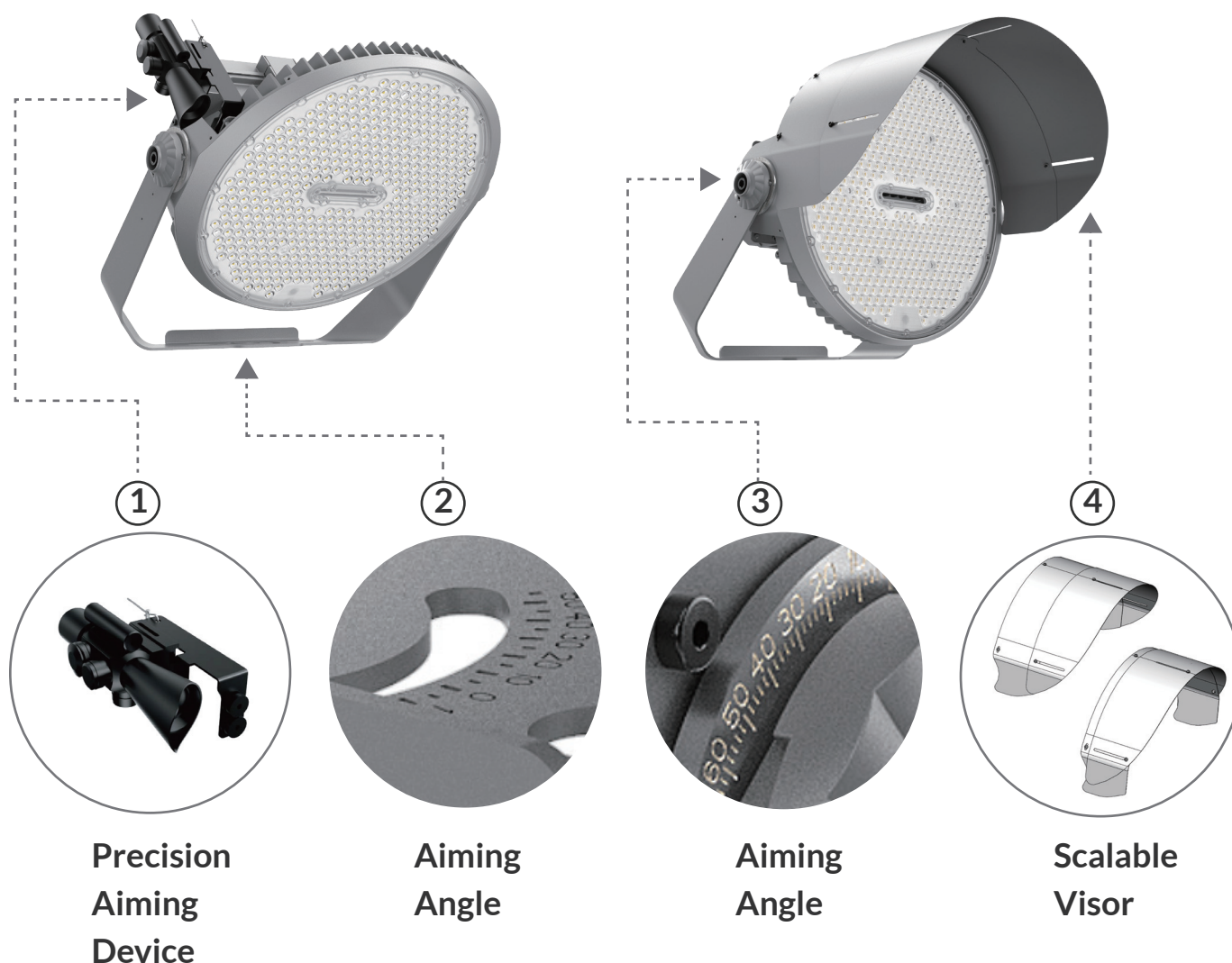

## WARRANTY

Five year limited warranty.

Specifications subject to change without notice.