

The APEX Stadium Light is a professional lighting solution for sports field and high mast area lighting. The professionally designed beam angle can target specific areas, minimizing glare and maintaining uniformity. The lamp body is made from low-copper die-cast aluminum, the bracket is made of ZAM/SPCC steel, and the lens is made from high-transmittance PC material. The LED chips are equipped with high level lightning protection. The installation angle can be infinitely adjusted through a rotatable mechanism. It supports standard bracket installation, as well as horizontal and vertical clamp or sleeve-type pole installations.

## TECHNICAL DATA

|                     |                             |
|---------------------|-----------------------------|
| Wattage             | 400/300/200W selectable     |
|                     | 600/500/400W selectable     |
|                     | 800/600/400W selectable     |
|                     | 1200/1000/800W selectable   |
| CCT                 | 5000K(4000K optional)       |
| CRI                 | 70                          |
| Dimming             | 0-10V dimming (10% - 100%)  |
| Input Voltage       | 120~277Vac/200-480Vac       |
| Projected Lifetime  | L70-600,000hrs @Ta=25°C     |
| Operating Temp.     | -30 to +40°C(-22 to +104°F) |
|                     | @120~277Vac                 |
|                     | -30 to +50°C(-22 to +122°F) |
|                     | @200~480Vac                 |
| Power Factor        | >0.97 at full load          |
| Harmonic Distortion | <20% at full load           |
| IP Rating           | IP66                        |
| Surge protection    | 10KV L-N, 20KV L/N-E        |
| IK Rating           | IK08                        |
| Certifications      | UL Listed                   |

## Features

- **Several Mounting Options:** Trunnion, slip fitter and quick clamp pendant.
- **Robust Construction:** low-copper die-cast aluminum-housing, ZAM/SPCC steel bracket, IK08-rated polycarbonate lens.
- **High Lumen Output:** From 200W to 1200W with high luminous efficacy up to 170 LM/W.
- **Optional Add-ons:** Zhaga Book 18 Receptacle. Precision aiming device and scalable visor can dramatically reduce glare and spill. The scalable visor can save 35% packaging volume.
- **Precise Control:** 12°, 17°, 22°, 30°, 45°, 60° via high performance optical lenses.

## DIMENSION

|            | Wattage | Luminaire Dimensions<br>AxBxC         | N.W/PC              |
|------------|---------|---------------------------------------|---------------------|
| 120~277Vac | 400SP   | 400x429x246mm<br>(15.75x16.89x9.68")  | 9.90kg<br>21.83lbs  |
|            | 600SP   | 426x490x291mm<br>(16.77x19.29x11.46") | 12.96kg<br>28.57lbs |
|            | 800SP   | 526x564x326mm<br>(20.71x22.20x12.83") | 17.41kg<br>38.38lbs |
|            | 1200SP  | 581x648x332mm<br>(22.87x25.51x13.07") | 25.14kg<br>55.42lbs |
| 200~480Vac | 400SP   | 400x429x246mm<br>(15.75x16.89x9.68")  | 10.83kg<br>23.88lbs |
|            | 600SP   | 426x490x291mm<br>(16.77x19.29x11.46") | 12.96kg<br>28.57lbs |
|            | 800SP   | 526x564x326mm<br>(20.71x22.20x12.83") | 17.60kg<br>38.80lbs |
|            | 1200SP  | 581x648x332mm<br>(22.87x25.51x13.07") | 25.14kg<br>55.42lbs |

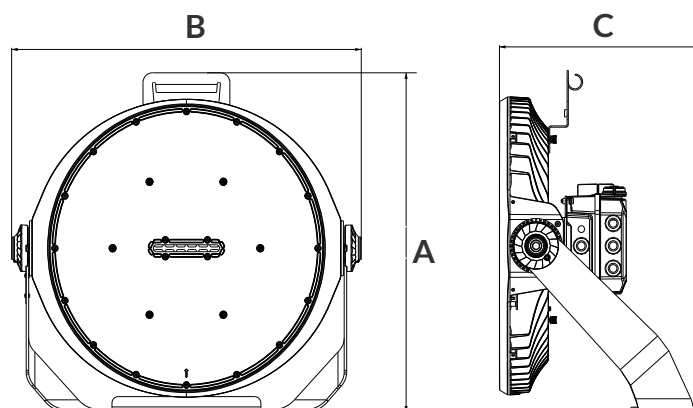

## PERFORMANCE DATA

| WATTAGE | CCT   | DISTRIBUTION            | LUMENS (lm)   | CRI | LPW     |
|---------|-------|-------------------------|---------------|-----|---------|
| 400W    | 5000K | 12°/17°/22°/30°/45°/60° | 66900~69100   | 70  | 167~172 |
| 600W    | 5000K | 12°/17°/22°/30°/45°/60° | 97800~103600  | 70  | 163~172 |
| 800W    | 5000K | 12°/17°/22°/30°/45°/60° | 132800~135800 | 70  | 166~170 |
| 1200W   | 5000K | 12°/17°/22°/30°/45°/60° | 198200~205100 | 70  | 165~171 |

## INSTALLATION



## ORDERING INFORMATION

EXAMPLE: APEX-800SP-50706-ZT-TR-60-GY

| <b>APEX</b> |   |                    |                    |  |  |                                    |  |   |
|-------------|---|--------------------|--------------------|--|--|------------------------------------|--|---|
| Series      | Wattage   | CCT                | CRI                | Voltage  | Control  | Installation                       | Optics   | Finish  |
| <b>APEX</b> | <b>400SP</b><br>Selectable <sup>1</sup><br>400W<br>300W<br>200W<br><br><b>600SP</b><br>Selectable <sup>1</sup><br>600W<br>500W<br>400W<br><br><b>800SP</b><br>Selectable <sup>1</sup><br>800W<br>600W<br>400W<br><br><b>1200SP</b><br>Selectable <sup>1</sup><br>1200W<br>1000W<br>800W | <b>50</b><br>5000K | <b>70</b><br>70CRI | <b>1</b><br>120-277V<br><br><b>6</b><br>200-480V | <b>Blank</b><br>None<br><br><b>ZT</b><br>Zhaga Book<br>18 Receptacle | <b>TR</b><br>Trunnion <sup>2</sup> | <b>12</b><br>12°<br>2Hx2V<br><br><b>17</b><br>17°<br>3Hx3V<br><br><b>22</b><br>22°<br>4Hx4V<br><br><b>30</b><br>30°<br>4Hx4V<br><br><b>45</b><br>45°<br>5Hx5V<br><br><b>60</b><br>60°<br>5Hx5V | <b>GY</b><br>Gray <sup>2</sup><br>sand<br>texture<br>(RAL870-3) |

### NOTES:

1. The highest wattage is default setting.
2. Trunnion is standard. Slip fitter and quick clamp adapter need to be ordered separately.
3. Gray is standard. Custom color is available at an additional charge.

## ACCESSORIES



**APEX-PAD-BK**  
Precision aiming  
device, black



**APEX-SF-GY**  
Slip fitter, gray



**APEX-QCA-GY**  
Quick clamp  
adapter, gray



**APEX-VS-400SP-GY**  
Visor for 400SP, gray

**APEX-VS-800SP-GY**  
Visor for 800SP, gray

**APEX-VS-600SP-GY**  
Visor for 600SP, gray

**APEX-VS-1200SP-GY**  
Visor for 1200SP, gray

## PHOTOMETRY

All published luminaire photometric testing performed to IESNA LM-79-08 standards by a NVLAP certified laboratory. IESNA LM-79-08 specifies the entire luminaire as the source resulting in a fixture efficiency of 100%. Results may vary per actual order.

### 600W

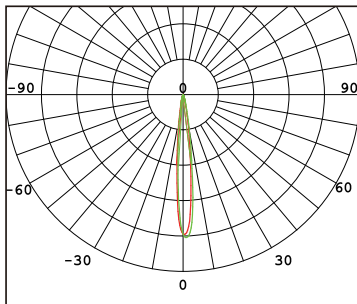

12°(NEMA 2Hx2V) LED3737 optics  
F34801

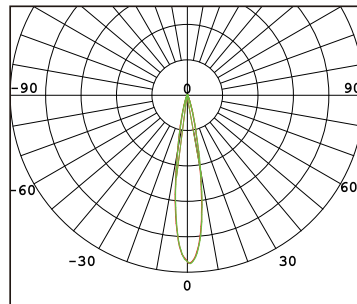

17°(NEMA 3Hx3V) LED3737 optics  
F34802

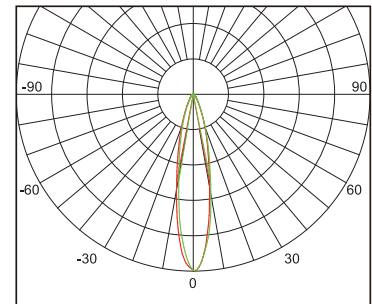

22°(NEMA 4Hx4V) LED5050 optics  
F34823

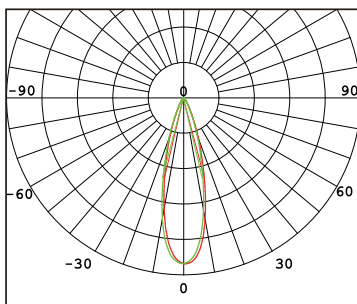

30°(NEMA 4Hx4V) LED5050 optics  
F34803

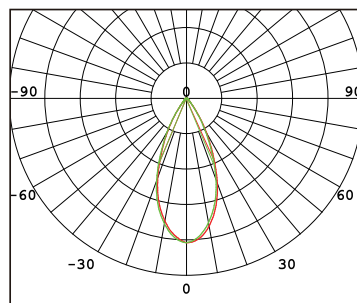

45°(NEMA 5Hx5V) LED5050 optics  
F34804

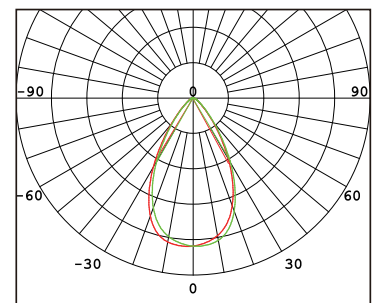

60°(NEMA 5Hx5V) LED5050 optics  
F34806

## PRECISION LIGHT CONTROL

The optional precision aiming device, aiming angles on the bracket and scalable visor are key elements in controlling the amount of light that is directed onto the field, with correct aiming angles generally directing more light onto the field resulting in less spill and glare off site. Dramatically reduces glare and spill.

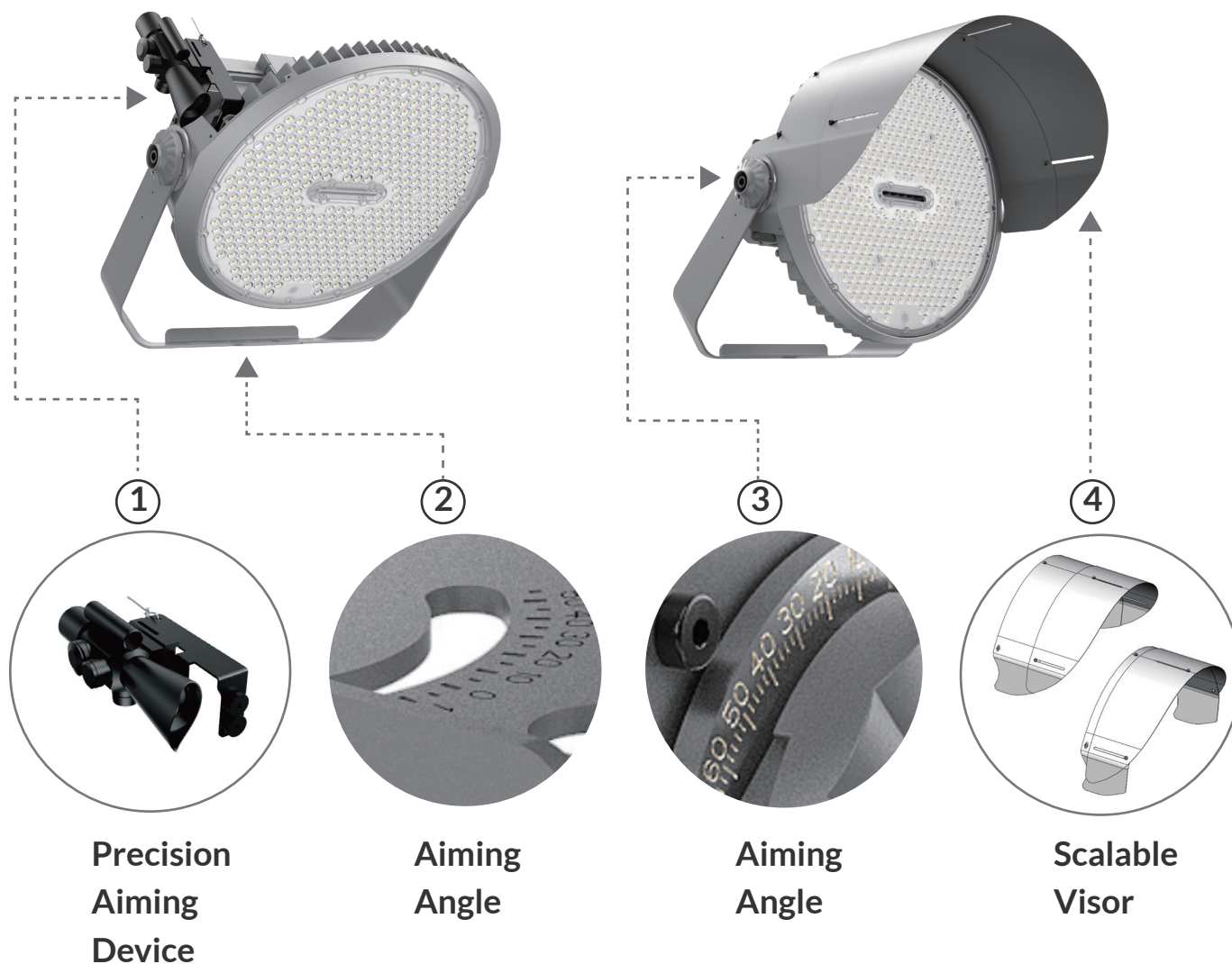

## BLUETOOTH PIR OCCUPANCY SENSOR



**BMS-S6-PIR-DC1-BLE-SR-ZT**

Zhaga Bluetooth Passive Infrared Sensor

Ref#: 20250819

## BLUETOOTH MESH CONTROL

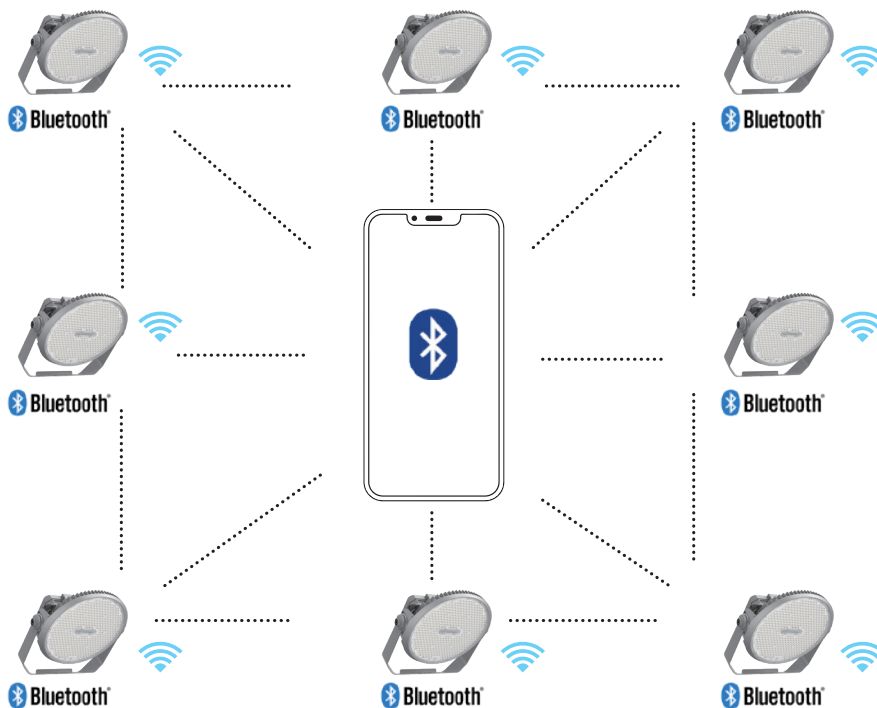

## DETECTION AREA

Coverage Side View

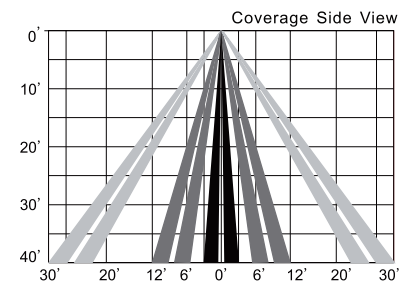

Coverage Plan View

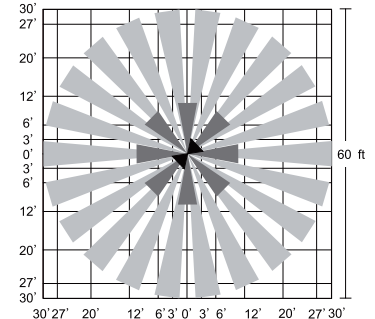

## PORT DESCRIPTION

- Port 1 : 12-24Vdc
- Port 2 : GND/DIM -
- Port 3 : DIM +
- Port 4 : NC

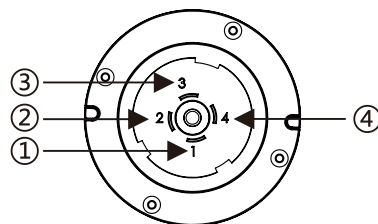

## WARRANTY

Five year limited warranty.

Specifications subject to change without notice.