

SUITABLE FOR MODEL

IMAGE MAY VARY FROM ACTUAL PRODUCT

SAFETY INSTRUCTION

READ CAREFULLY BEFORE INSTALLING FIXTURE. PLEASE KEEP THIS MANUAL FOR FUTURE USING.

Fixtures must be wired in accordance with the National Electrical Code and all applicable local codes. Proper grounding is required for safety.

THIS PRODUCT MUST BE INSTALLED IN ACCORDANCE WITH THE APPLICATION CODE BY A PERSON FAMILIAR WITH THE CONSTRUCTION AND OPERATION OF THE PRODUCT AND THE HAZARDS INVOLVED. MAKE CERTAIN POWER OFF BEFORE INSTALLING OR MAINTAINING FIXTURE.

CHECK THAT VOLTAGE IS COMPATIBLE WITH FIXTURE DRIVER, USE APPROVED CONNECTORS FOR ALL ELECTRICAL CONNECTIONS.

THE DISTANCE BETWEEN CEILING AND FIXTURE IS 39.3" (1M) AT LEAST. AVERAGE AMBIENT TEMPERATURE IS FROM -4-104°F (-20-40°C).

MAINTENANCE CAUTION

1. Review the wire connection before beginning, and make sure fixture is grounded properly.
2. For lighting controls, using functioning correctly.
3. Turn power off and wait for fixture cooling to operate.
4. Maintenance must be done by professionals.

WIRE CONNECTION

1). Universal voltage driver permits operation at 120V thru 277V, 50/60Hz with 0-10V dimming

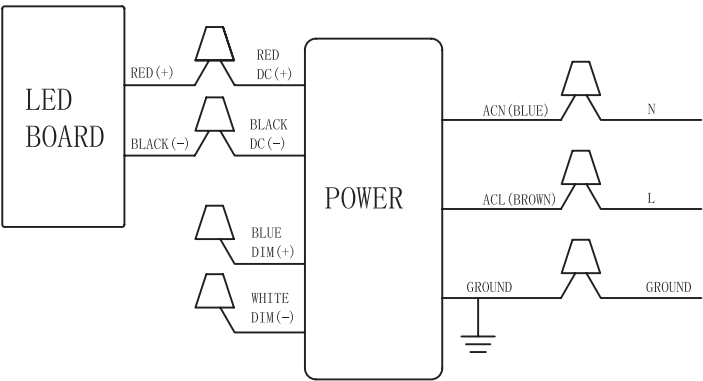

2). Universal voltage driver permits operation at 120V thru 277V, 50/60Hz with motion sensor

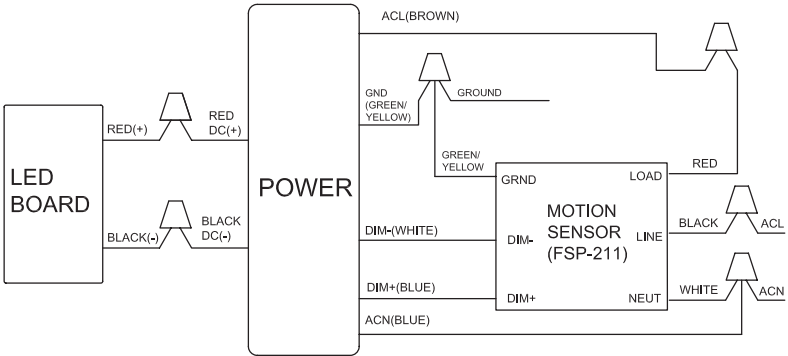

3). Universal voltage driver permits operation at 120V thru 277V, 60Hz with MSO

4). High voltage driver permits operation at 347V, 60Hz with MSO

1). With Motion Sensor (MS) Option



Specifications

- Time delay: 30 sec., 5-30 min.; default 5 min.
- Cut off delay: none, 1-60 min. 1-5 hrs.; default 1 hr.

Side and Top Coverage Patterns

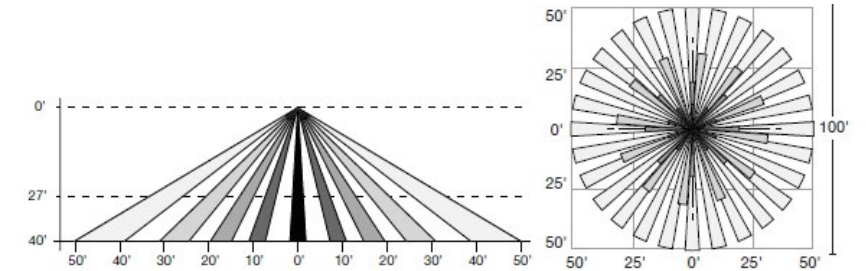

360° lens, maximum coverage 100' diameter from 40' height

5). High voltage driver permits operation at 480V, 60Hz with MSO

2). With Occupancy Sensors Option



Specifications

- Factory preset 15-minute time delay
- IP65 rated

Side and Top Coverage Patterns

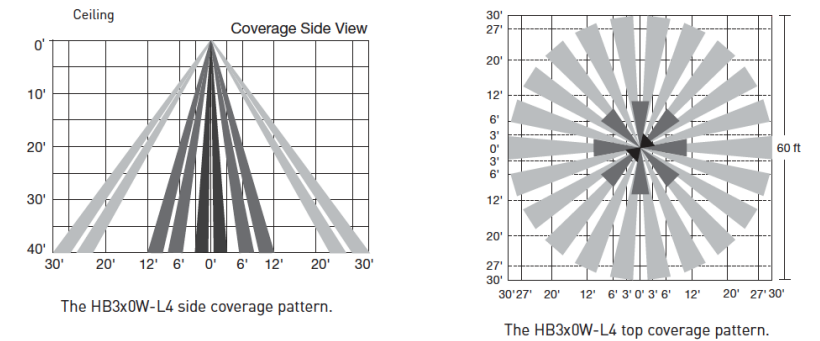

Wet location 360° lens, 60' diameter coverage from 40' height

INSTALLATION

Installation: Using Standard hanging V-Clips and chain

1. Loop the **chain** around the ceiling or service attachment point.
2. Use an **S** or **similar connector** to close the loop.
3. Slide the other end of the **chain** through the **V-Clip** provided with the fixture. Install the **V-Clip** into the **two slots** shown above to support the fixture. The distance between ceiling and fixture is 39.3" (1m) at least.

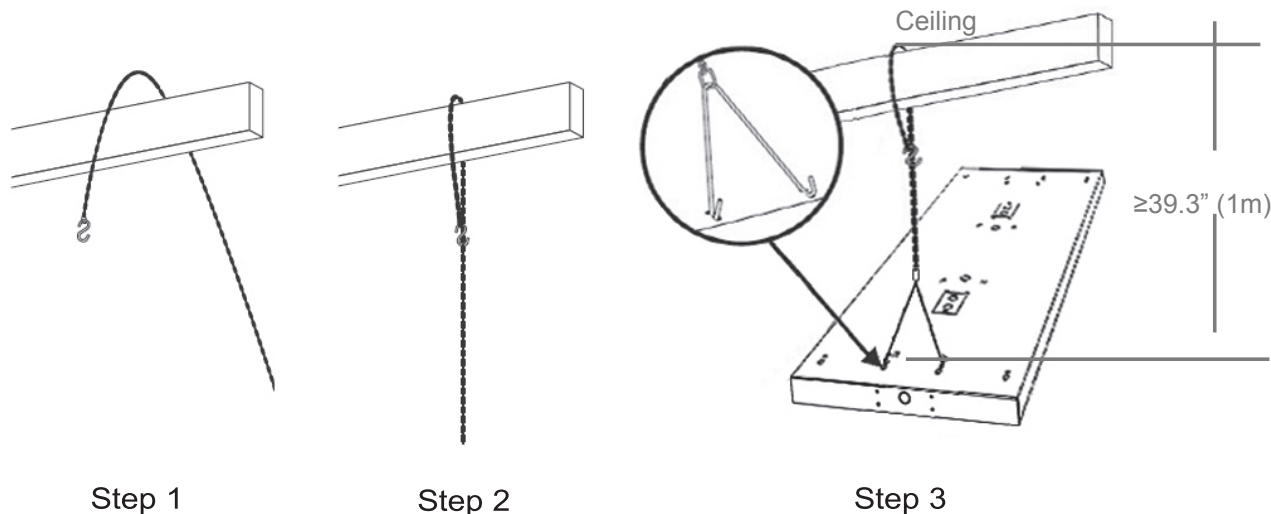

WARRANTY

LIMITED FIVE-YEAR WARRANTY. Should this product fail to perform satisfactorily due to a defect or poor workmanship within five years from the date of purchase, return it to the place of purchase and it will be replaced, free of charge. Incidental or consequential damages are excluded from the warranty.