

BRITUBE LINEAR LIGHT



PRODUCT DESCRIPTION

The Britube linear fixture features in streamline tube shape with aluminum base and frosted polycarbonate lens. It is designed to deliver direct and indirect lighting to commercial spaces. 3000K, 3500K, 4000K and 5000K are in one. Sensor and emergency back-up optional. The Britube linear fixture is available in standard lengths of 4', 8' and can be joined together in seamless runs. Highly effective and efficient lighting solutions for offices, retail outlets, storage rooms, conference rooms, hallways and more.

FEATURE

- Aluminum base and frosted polycarbonate lens
- 3000K, 3500K, 4000K and 5000K are in one
- Direct and indirect distribution
- Sensor and emergency back-up optional
- Special end caps design for easy run mount

ELECTRICAL SYSTEM

- Input Voltage: 120-277V, 120-347V, 50/60Hz
- 0-10V Dimming optional
- Minimum Ambient -20°C, Maximum Ambient is 40°C
- Power Factor: > 0.9 at full load
- Total Harmonic Distortion: < 20% at full load

SPECIFICATION

4FT

Net Weight: 6.8lbs / 3.1kg

8FT

Net Weight: 12.8 lbs / 5.8 kg

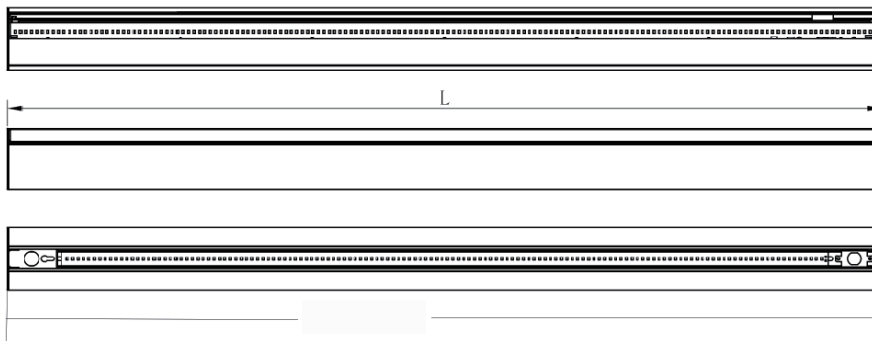

47.17 inch

94.02 inch

3.39 inch

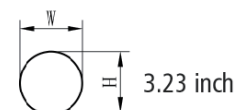

3.23 inch

PERFORMANCE

CRI

80

CCT

3000K, 3500K, 4000K, 5000K

Dimming

0-10V Dimming

Projected Lifetime

L70 - 100,000 Hours

Working Temperature

-4-104°F (-20-40°C)

Certifications

- cULus listed
- Suitable for dry locations
- RoHs compliant

Ordering Information

Example: BIT12ID40SW1

Series	Length	Distribution	Watts	CCT	Voltage	Installation	Controls	Finish
BIT	12- 4FT	D - Direct	40- 40W	SW- 3000K/3500K 4000K/5000K Selectable ¹	1- 120-277V ² 8- 120-347V ²	Blank - Pendant ³	Blank - None MSW - Microwave Dimming Sensor ⁴ EBU - Emergency Battery Back-up ⁵	Blank - White
	24- 8FT	ID - Indirect and Direct	80- 80W					

Notice:

- 3500K is default setting.
- 120-277V is standard. 120-347V is optional.
- Pendant Mount Kits need to be bought separately.
- Microwave dimming sensor, for mounting height 40ft (12m) max. Dimming default setting is Bi-Level dim and dimming to 30%. Other dimming levels, ON/OFF function and daylight sensor can be set by the remote controller RC-100.
- Emergency battery back-up is for ambient temperatures of 32°F -104°F (0 °C -40°C).

* White finish is standard. Custom color is available for a premium setup fee. Consult customer service for additional information.

Accessories (Ordered separately)



90535
RC-100
Remote control for MSW



90737
BIT/ARC- PMK
Pendant Mount Kit



91488
BIT- CRMK
Continuous Run Mount Kits



91489
BIT- LCMK
L Corner Mount Kits

* Continuous run can't exceed 400W.

PHOTOMETRY

All published luminaire photometric testing performed to IESNA LM-79-08 standards by a NVLAP certified laboratory. Result may vary per actual order.

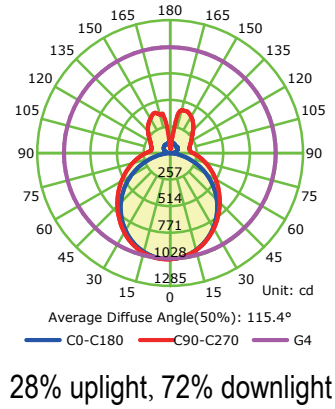
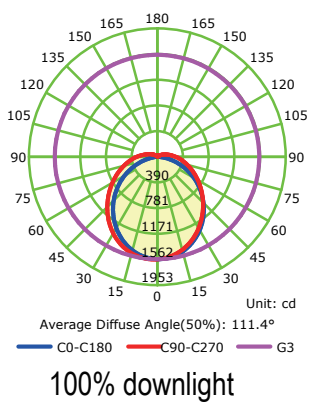

PERFORMANCE DATA

LUMEN OUTPUT

Lumen values are measured by third party certified laboratories performed in accordance with IESNA LM-79-08 as well as Lighting Facts listed.

Watts	Measured Watts	Lumen Output	AC Input 120V	CCT	CRI	LPW
40	38	4400	0.33A	4000K	80	117
80	80	9200	0.67A	4000K	80	115

PATTERNS

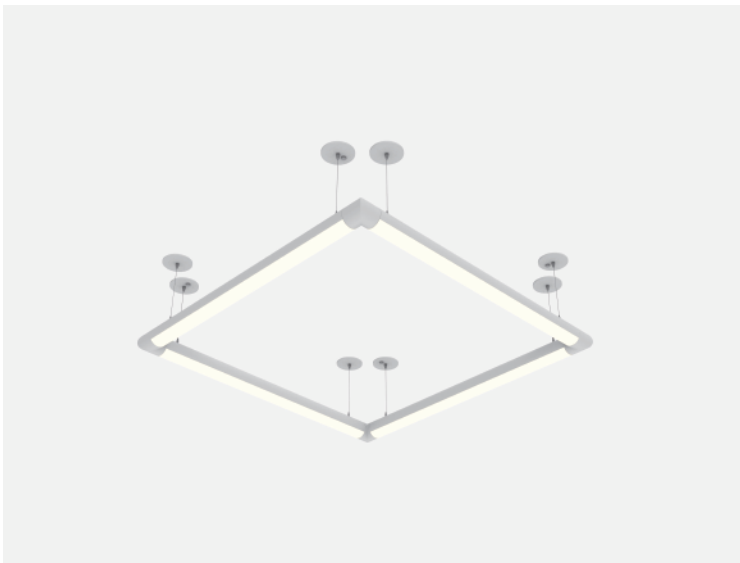

PIR Dimming SENSOR SETTING (BRI820-M7)

By selecting the combination on the DIP switch, sensor data can be precisely set for each specific application.

The sensor setting also can be done by a remote control (RC-100) which need to be bought separately.

	1	2	
I	↓	↓	20%
II	↓	↑	50%
III	↑	↓	75%
IV	↑	↑	100%

Sensitivity

Sensitivity can be reduced by selecting the combination on the DIP switches to fit precisely each application .

Default Setting: 100%

	3	4	
I	↓	↓	10 S
II	↓	↑	1 Min
III	↑	↓	5 Min
IV	↑	↑	15 Min

Hold time

Refers to the time period the lamp remains at 100% illumination after no motion detected.

Default Setting: 1min

	5	6	
I	↓	↓	☀
II	↓	↑	10 Lux
III	↑	↓	30 Lux
IV	↑	↑	50 Lux

Daylight sensor

The sensor can be set to only allow the lamp to illuminate below a defined ambient brightness threshold.

Default Setting: ☀

	7	8	
I	↓	↓	0%
II	↓	↑	10%
III	↑	↓	30%
IV	↑	↑	50%

Stand-by dimming level

The low light level you would like to have after the hold time in the long absence of people.

Default Setting: 30%

	9	10	
I	↓	↓	+ ∞
II	↓	↑	1 Min
III	↑	↓	30 Min
IV	↑	↑	60 Min

Stand-by time

Refers to the time period the lamp remains at a low light level before it completely switches off in the long absence of people. When set to " +∞ " mode, the low light is maintained until motion is detected

Default Setting: 30Min

Warranty

Five year limited warranty.

Notes: Specifications subject to change without notice.