

**SURFACE MOUNT FRAME**

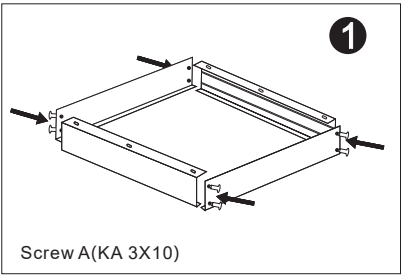

1. Assemble the four frames with Screw A to a whole square.

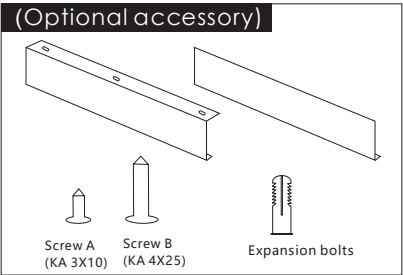
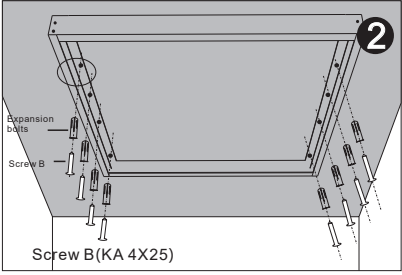

2. Fix the square frames to the ceiling with Screw B.

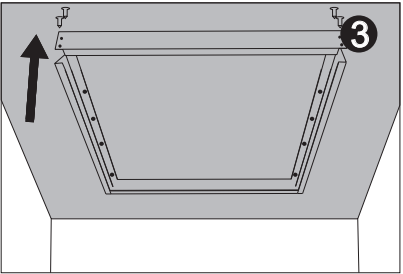

3. Demount one frame

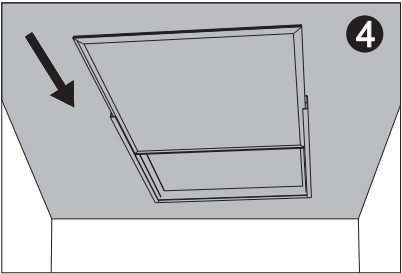

4. Put the panel into the frame square.

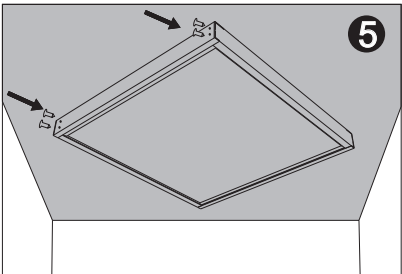

5. Fix the last frame with screw A.

**RECESSED MOUNT FRAME**

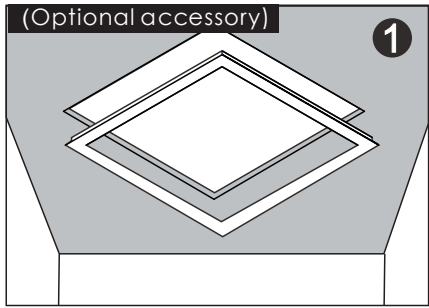

1. Put the frame into the hole

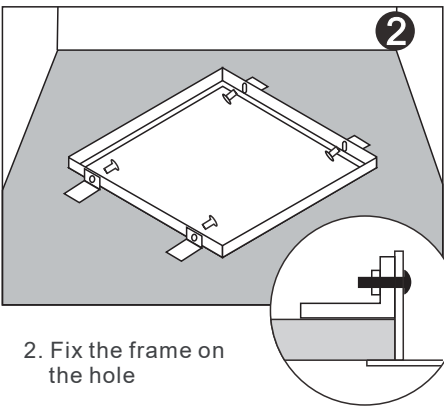

2. Fix the frame on the hole

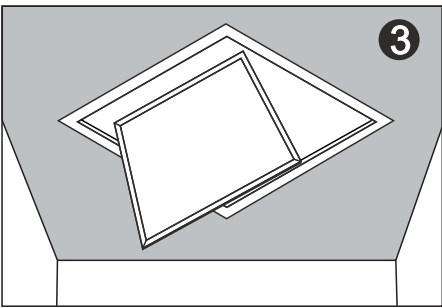

3. put the panel in to the recessed mounted frame.

**SUSPENDED MOUNT**

(Optional accessory)

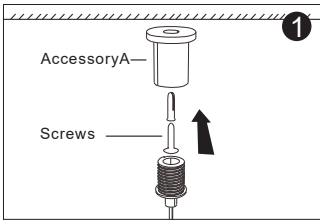

1. Screwing accessories A in ceiling

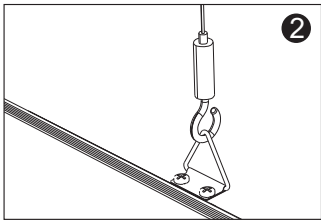

2. Triangle rings for hooks



3. Finished installation

Ref#: 20250624

**SUITABLE FOR MODEL**

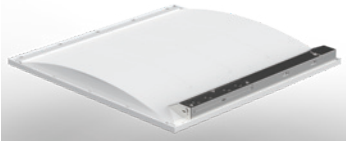

**SAFETY INSTRUCTION**

**READ CAREFULLY BEFORE INSTALLING FIXTURE. PLEASE KEEP THIS MANUAL FOR FUTURE USING.** Fixtures must be wired in accordance with the National Electrical Code and all applicable local codes. Proper grounding is required for safety. **THIS PRODUCT MUST BE INSTALLED IN ACCORDANCE WITH THE APPLICATION CODE BY A PERSON FAMILIAR WITH THE CONSTRUCTION AND OPERATION OF THE PRODUCT AND THE HAZARDS INVOLVED. MAKE CERTAIN POWER OFF BEFORE INSTALLING OR MAINTAINING FIXTURE. CHECK THAT VOLTAGE IS COMPATIBLE WITH FIXTURE DRIVER, USE APPROVED CONNECTORS FOR ALL ELECTRICAL CONNECTIONS.**

**MAINTENANCE CAUTION**

1. Review the diagrams before beginning, and make sure fixture is grounded properly.
2. For lighting controls, using functioning correctly.
3. Turn power off and wait for fixture cooling to operate.
4. Maintenance must be done by professionals.

**WIRE CONNECTION**

**0-10V dimming**

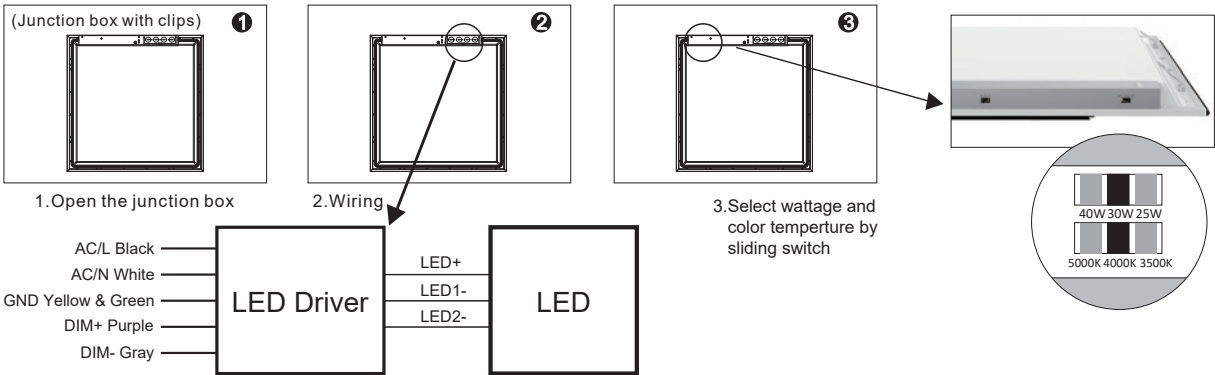

**INSTALLATION**

**RECESSED MOUNT**

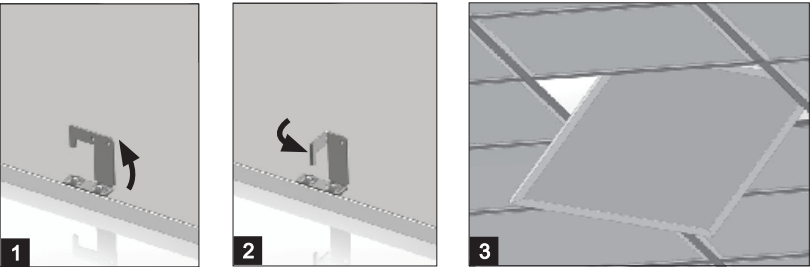

**SIZE AND WATTAGE**

SPEC	Size(Inch)	Wattage (W )
1 x 4	11.93" X 47.72" X 1.18"	25-30-40
2 x 2	23.7" X 23.7" X 1.97"	25-30-40
2 x 4	23.7" X 47.72" X 1.97"	30-40-50