

### ⚠ CAUTION! Risk Of Electric Shock

⚠ Turn off all power prior to installation by switching off circuit breaker or removing fuse at fuse box.

Installation requires knowledge of the lighting luminaires electrical systems. If not qualified, do not attempt installation and contact a qualified electrician.

### NOTES

1. Indoor lighting only.
2. Before installation, ensure the LED panel is not damaged.
3. Don't stare at the LED luminous surface for long time.
4. Keep away from children, and ensure working electrical apparatus inaccessible to them.
5. No packages accessible to children, because they might be choked for playing, or eating the small accessories.
6. No covering, be away from fire or high-temperature substance.
7. Manufacturer reserves the right to offer no replacement or warranty to the led panels disassembled or repaired by users themselves.
8. Cut off power before cleaning the panels with dry cloth, use no chemical or corrosive substance.
9. Cut off power before installation.
10. The light source of this luminaire is not replaceable; when the light source reaches its end of life the whole luminaire shall be replaced.

### WIRE CONNECTION

#### 0-10V dimming

1. Open the junction box

2. Wiring

3. Close the junction box plate

(Junction box with clips, no screw)

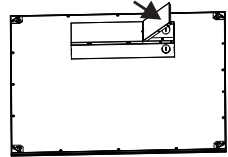

①

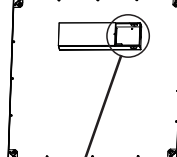

②

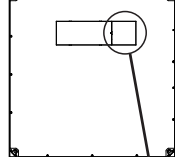

③

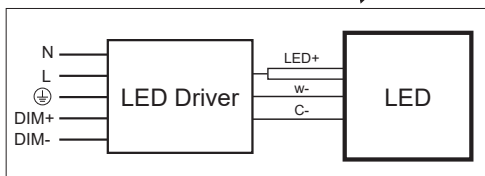

### SIZE AND WATTAGE

SPEC	Size(Inch)	N. W. / lbs	Wattage (W )
1 x 4	11.73" X 47.6"	5.1lbs	25-30-40
2 x 2	23.7" X 23.7"	4.4lbs	25-30-40
2 x 4	23.7" X 47.6"	9.1lbs	30-40-50

! Please confirm the dimensions of the ceiling channel and the lamp is matching.

! Please confirm load-bearing is enough to support the lamp.

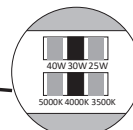
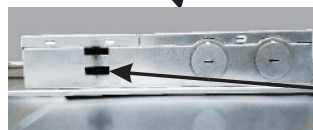

Make the following Electrical Connections See **Left Figure**

- a. Connect the voltage supply Line to our AC-L terminal
- b. Connect the voltage Neutral supply to our AC-N terminal
- c. Connect the green/yellow ground lead to the supply ground lead
- d. If 0-10V Dimming is used, connect the supply positive dimming lead to our 0-10V(Dim+) terminal
- e. If 0-10V Dimming is used, connect the supply negative dimming lead to our 0-10V(Dim-) terminal

**Note: If the power supply needs to be connected in a daisy chain, please contact with factory in advance.**

\*\*Consult with dimmer control manufacturer's wiring instructions

### INSTALLATION

#### RECESSED MOUNT (standard)

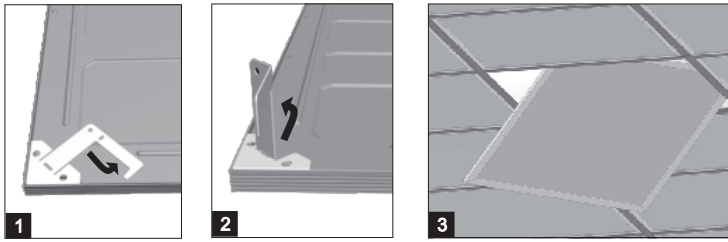

#### SUSPENSION MOUNT (mounting cable needs to be bought separately)

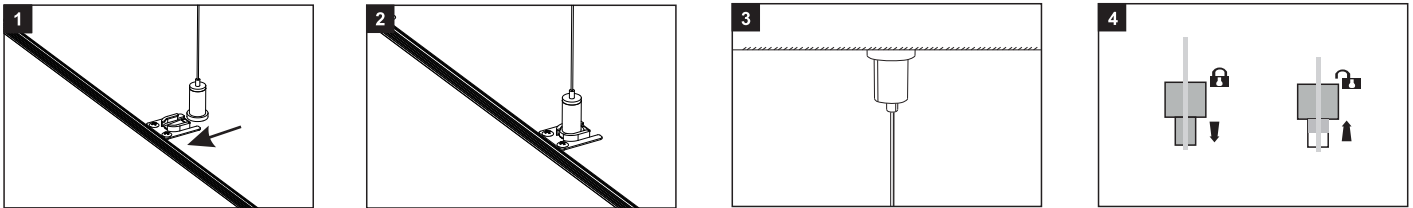

#### SURFACE MOUNT (mounting accessories need to be bought separately)

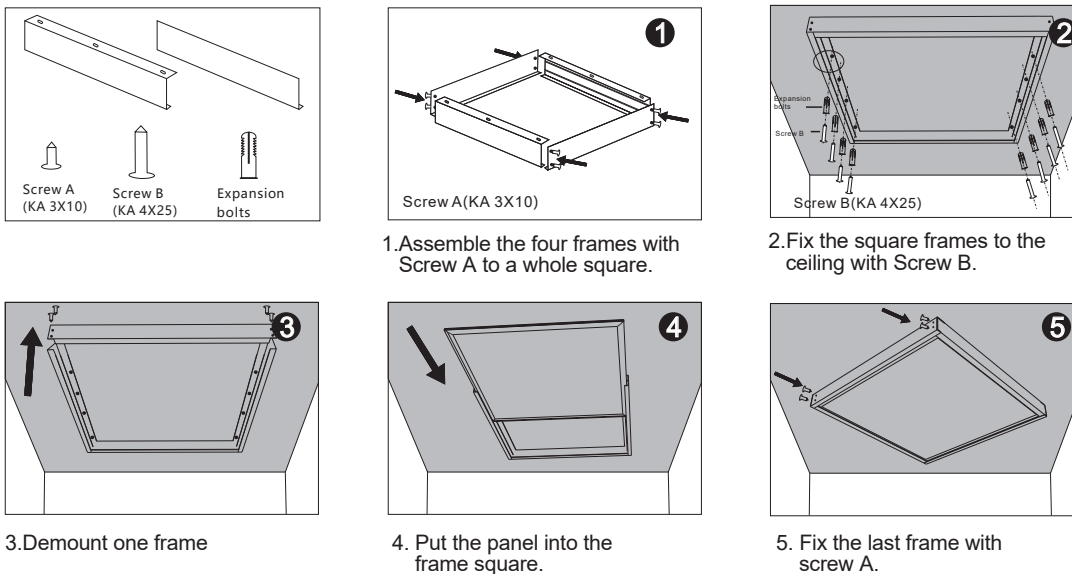

#### FLANGE KIT MOUNT (mounting accessories need to be bought separately)

