

GALENE LED WALL LIGHT

Direct Light



The Galene Wall Light is designed in a round or square shape with durable powder coat paint. It combines aluminum structure with a tempered glass diffuser radiating light downward against the wall where installed.

TECHNICAL DATA

Wattage	Selectable 10W/20W
CRI	70
CCT	Selectable 3000K/4000K/5000K
Input Voltage	120-347VAC, 50/60Hz
Operating Temp.	-40°F to 104°F(-40°C to 40°C)
Driver	Non dimming
Certifications	cUL Listed
	Suitable for wet locations
	RoHS compliant
Power Factor	>0.9 at full load
Projected Lifetime	L70 - 100,000 Hours

FEATURES

- **Shape Options:** Round and square shapes available, providing direct light distribution.

SPECIFICATION

Round Shape

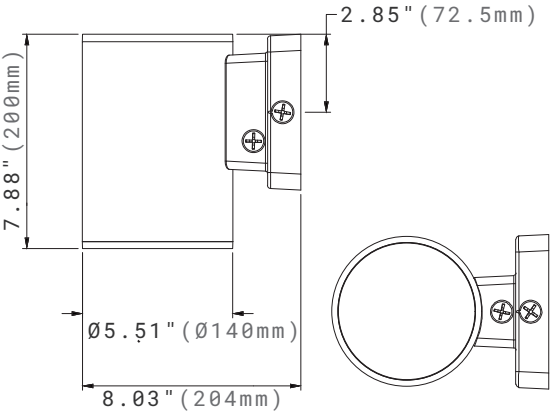

Square Shape

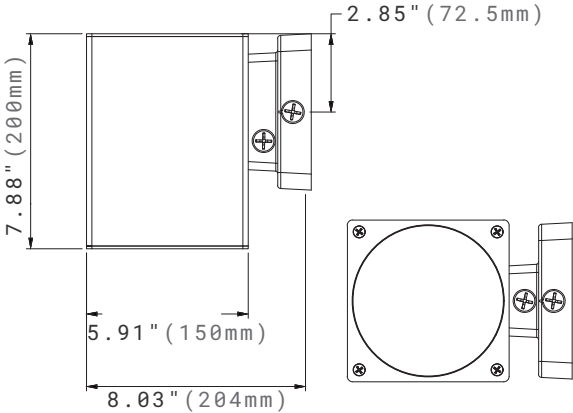

ORDERING INFORMATION

EXAMPLE: GD-RSP-SW8-60-BK

GD							
Series	Shape	Wattage	CCT	Voltage	Control	Beaming Angle	Finish
GD Galene Direct	R Round S Square	SP Selectable Power 10W 20W ¹	SW Selectable White 3000K 4000K ² 5000K	8 120-347V	BLANK On/Off	25 25° 45 45° 60 60°	BK Black ³

NOTE:

- 1. 20W is the default setting. 10W can be set by the DIP switch on the fixture.
- 2. 4000K is the default setting. If other CCT is needed, please contact Customer Service in advance to change the setting in factory or change the setting in the field.
- 3. Standard Finish is Black. Additional charge will apply for custom finish.

PHOTOMETRY

All published luminaire photometric testing performed to IESNA LM-79-08 standards by a NVLAP certified laboratory. IESNA LM-79-08 specifies the entire luminaire as the source resulting in a fixture efficiency of 100%. Results may vary per actual order.

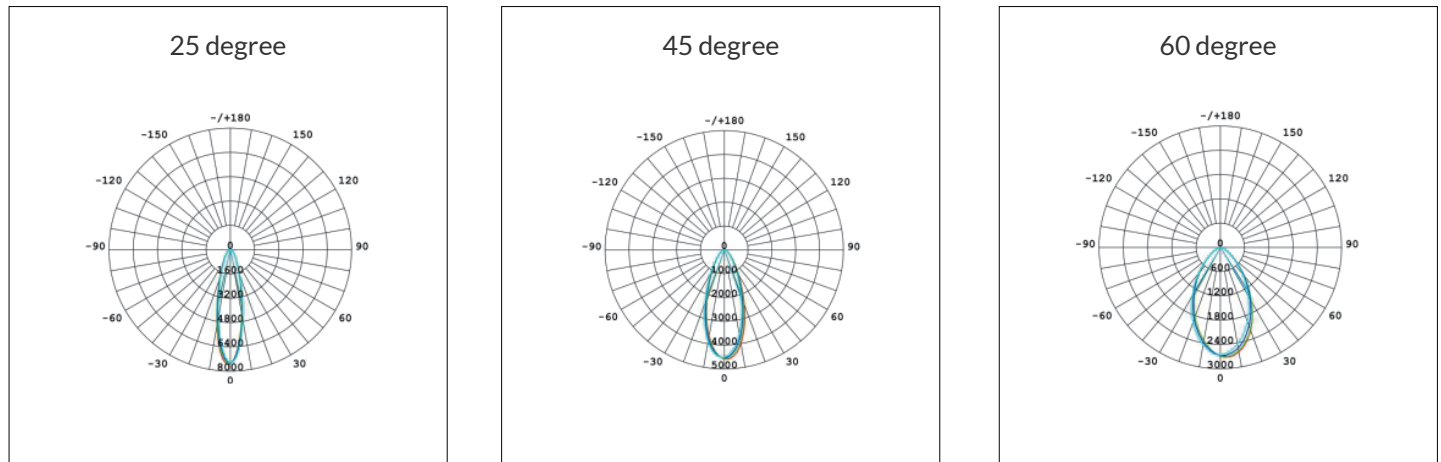

BUG RATING TABLE

Performed to IESNA LM-79-08 standards by a NVLAP accredited laboratory.

Model	BUG Rating	Model	BUG Rating
GD-RSP-SW8-10W-3000K-25D	B2-U0-G0	GD-RSP-SW8-20W-3000K-25D	B3-U0-G0
GD-RSP-SW8-10W-3000K-45D	B1-U0-G0	GD-RSP-SW8-20W-3000K-45D	B2-U0-G0
GD-RSP-SW8-10W-3000K-60D	B1-U0-G0	GD-RSP-SW8-20W-3000K-60D	B2-U0-G0
GD-RSP-SW8-10W-4000K-25D	B2-U0-G0	GD-RSP-SW8-20W-4000K-25D	B3-U0-G0
GD-RSP-SW8-10W-4000K-45D	B1-U0-G0	GD-RSP-SW8-20W-4000K-45D	B2-U0-G0
GD-RSP-SW8-10W-4000K-60D	B1-U0-G0	GD-RSP-SW8-20W-4000K-60D	B2-U0-G0
GD-RSP-SW8-10W-5000K-25D	B2-U0-G0	GD-RSP-SW8-20W-5000K-25D	B3-U0-G0
GD-RSP-SW8-10W-5000K-45D	B1-U0-G0	GD-RSP-SW8-20W-5000K-45D	B2-U0-G0
GD-RSP-SW8-10W-5000K-60D	B1-U0-G0	GD-RSP-SW8-20W-5000K-60D	B2-U0-G0

PERFORMANCE DATA

Lumen values are measured by third party certified laboratories performed in accordance with IESNA LM-79-08 as well as Lighting Facts listed.

Nominal Wattage	Lumen Output	AC Input 120V	CCT	BeamAngle	CRI	LPW
20W	2260lm	0.17A	4000K	45°	70	113
10W	1200lm	0.08A	4000K	45°	70	120

NOTE:

1. 0.92 multiplier is for 3000K and 5000K.

WARRANTY

5 years limited warranty.

Specifications subject to change without notice.