



The Sceley LED Wall Light ultra modern, stylistic design and smooth curvature, exudes a tidy appearance. Clear, 360° polycarbonate shade completely eliminates blind spots caused by lamp arms. Power selectable, CCT selectable. Photocell, microwave motion sensor optional. Confidently suited for outdoor lighting applications such as landscape, courtyards, roadways.

## TECHNICAL DATA

Wattage	Selectable 18W/30W/45W/60W
CRI	70-Standard
	80-Optional
CCT	Selectable 3000K/4000K/5000K
Input Voltage	120-277VAC, 50/60Hz
Operating Temp.	-40°F to 104°F(-40°C to 40°C )
Driver	0-10V dimming
Certifications	cETL Listed
	RoHS compliant
Power Factor	>0.9 at full load
Harmonic Distortion	<20% at full load
Projected Lifetime	L70 - 100,000 Hours
IP Rating	IP65
IK Rating	IK09

## FEATURES

- **Reliable Design:** High quality 360° polycarbonate shade that prevents yellowing and ensures long-lasting clarity, with 10kV surge suppression available.
- **Power & CCT Selectable:** Flexible settings with selectable wattage and CCT to meet diverse application needs.
- **Control Options:** Compatible with photocell for energy-saving automatic operation.

## SPECIFICATION

Net Weight : 4.6kg(10.12lbs)

EPA : 0.98ft<sup>2</sup>/0.09m<sup>2</sup>

### Wall Light

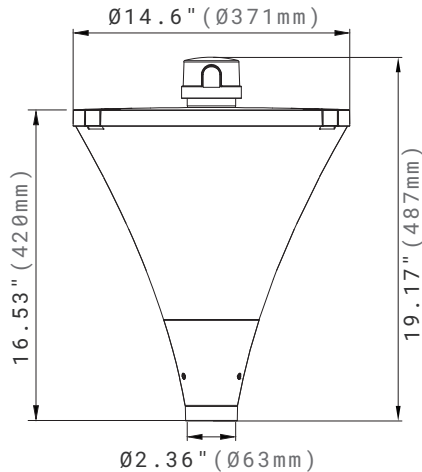

### Wall Mount Bracket

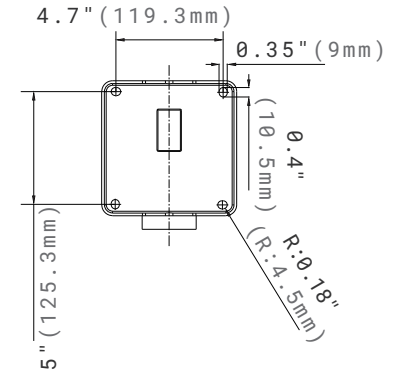
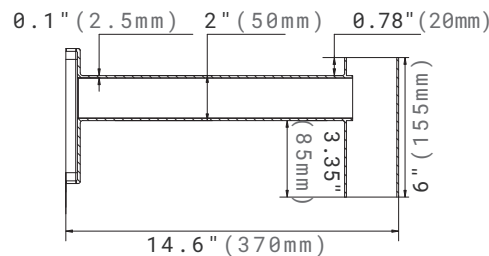
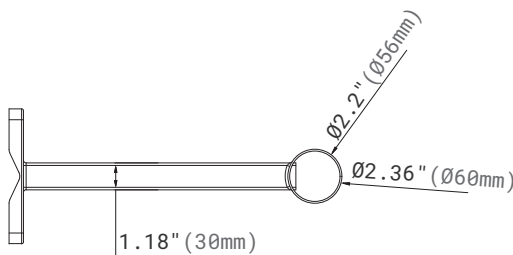

## PERFORMANCE DATA

Lumen values are measured by third party certified laboratories performed in accordance with IESNA LM-79-08 as well as Lighting Facts listed.

Nominal Wattage	Lumen Output	CCT	Distribution Type	CRI	LPW
18W	2520lm	4000K	Type V	>70	140
30W	4200lm	4000K	Type V	>70	140
45W	6300lm	4000K	Type V	>70	140
60W	8000lm	4000K	Type V	>70	133

## ORDERING INFORMATION

EXAMPLE: SCPT-60SP-SW1-V-BK

SCPT							
Series	Wattage	CCT	Voltage	Control	Installation	Distribution	Finish
SCPT	60SP Selectable 60W <sup>1</sup> 45W 30W 18W	SW Selectable 3000K 4000K <sup>2</sup> 5000K	1 120-277V	BLANK 0-10V dimming  PC Photoelectric Control  MSW Microwave Motion Sensor <sup>3</sup>	BLANK 2 3/8" Tenon Pole	I Type I  II Type II  III Type III  IV Type IV  V Type V	BK Black <sup>4</sup> (RAL9017)

### NOTE:

- 60W is default setting.
- 4000K is default setting.
- Microwave dimming sensor for mounting height up to 40ft (12m) max. A variety functions can be set by the remote controller AAL-RC-100.
- Standard Finish is Black. Custom colors may be available for an additional fee. Please contact Customer Service for more information.

## ACCESSORIES (ORDER SEPARATELY)



**WM-BRACKET-01-BK**  
Wall Mount Brackets.



## DAYLIGHT HARVEST MICROWAVE SENSOR SETTING (ANT-9)

By selecting the combination on the DIP switch, sensor data can be precisely set for each specific application.

The sensor setting also can be done by a remote control (RC-100) which need to be bought separately.

	1	2	
I	↓	↓	20%
II	↓	↑	50%
III	↑	↓	75%
IV	↑	↑	100%

### Sensitivity

Sensitivity can be reduced by selecting the combination on the DIP switches to fit precisely each application.

**Default Setting: 100%**

	3	4	
I	↓	↓	10s
II	↓	↑	1min
III	↑	↓	5min
IV	↑	↑	15min

### Hold time

Refers to the time period the lamp remains at 100% illumination after no motion detected.

**Default Setting: 1min**

	5	6	
I	↓	↓	
II	↓	↑	10 lux
III	↑	↓	30 lux
IV	↑	↑	50 lux

### Daylight sensor

The sensor can be set to only allow the lamp to illuminate below a defined ambient brightness threshold.

**Default Setting: 30 lux**

	7	8	
I	↓	↓	0%
II	↓	↑	10%
III	↑	↓	30%
IV	↑	↑	50%

### Stand-by dimming level

The low light level you would like to have after the hold time in the long absence of people.

**Default Setting: 30%**

	9	10	
I	↓	↓	+∞
II	↓	↑	1min
III	↑	↓	30min
IV	↑	↑	60min

### Stand-by time

Refers to the time period the lamp remains at a low light level before it completely switches off in the long absence of people. When set to " +∞ " mode, the low light is maintained until motion is detected.

**Default Setting: +∞**

PHOTOMETRY

All published luminaire photometric testing performed to IESNA LM-79-08 standards by a NVLAP certified laboratory. IESNA LM-79-08 specifies the entire luminaire as the source resulting in a fixture efficiency of 100%. Results may vary per actual order.

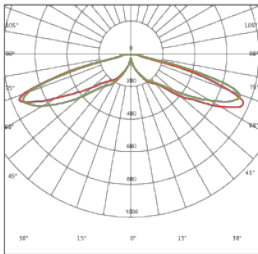

Type V

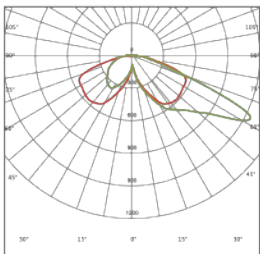

Type IV

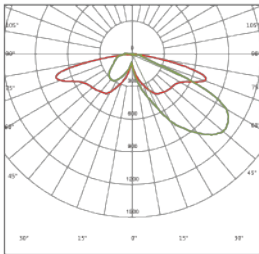

Type III

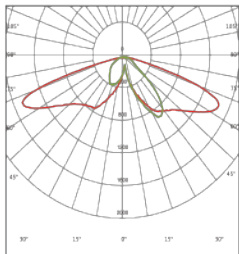

Type II

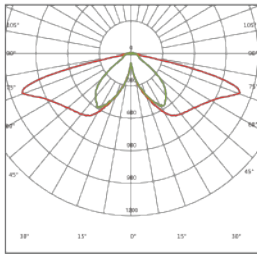

Type I

BUG RATING TABLE

Performed to IESNA LM-79-08 standards by a NVLAP accredited laboratory.

Model	BUG Rating
SCPT-60SP-SW1-V, 3000K	B3-U3-G2
SCPT-60SP-SW1-V, 4000K	B3-U3-G3
SCPT-60SP-SW1-V, 5000K	B3-U3-G2
SCPT-60SP-SW1-IV, 3000K	B2-U3-G3
SCPT-60SP-SW1-IV, 4000K	B2-U3-G3
SCPT-60SP-SW1-IV, 5000K	B2-U3-G3
SCPT-60SP-SW1-III, 3000K	B2-U3-G2
SCPT-60SP-SW1-III, 4000K	B2-U3-G2
SCPT-60SP-SW1-III, 5000K	B2-U3-G2
SCPT-60SP-SW1-II, 3000K	B2-U3-G2
SCPT-60SP-SW1-II, 4000K	B2-U3-G2
SCPT-60SP-SW1-II, 5000K	B2-U3-G2
SCPT-60SP-SW1-I, 3000K	B2-U3-G2
SCPT-60SP-SW1-I, 4000K	B3-U3-G3
SCPT-60SP-SW1-I, 5000K	B3-U3-G3

WARRANTY

5 years limited warranty.  
Specifications subject to change without notice.